



Your event,
our venue.



Located in San Juan, Puerto Rico's capital city, the **Puerto Rico Convention Center Dr. Pedro Rosselló** is just steps from a rich array of cultural attractions, historic treasures and architectural masterpieces, some of which date back centuries to when the city was a Spanish military stronghold. But it's not just the city's rich history that attracts visitors, San Juan is also home to numerous fine dining and casual restaurants offering a variety of cuisine from around the globe, a lively nightlife scene and a plethora of shops and attractions. The city also features a sophisticated business atmosphere that caters to both U.S. and international travelers. It is home to Fortune 500 companies that do business globally. With the most sophisticated technology and telecommunications available throughout the Region, guests will benefit from features such as satellite feeds, high-speeds Internet and video conferencing. And it is easy to get to the Island with hundreds of non-stop flights in and out of Luis Muñoz Marín International Airport (SJU) every day.



QUICK FACTS

Range of Hotels: Over 900 hotel rooms are within the Convention District. The Sheraton Puerto Rico Hotel & Casino with 503 rooms is just steps away from the Center and is one of the many hotels in the Metropolitan San Juan area that offers high-end services to delegates. The Hyatt Place, San Juan offers 149 rooms & Hyatt House. San Juan offers 126 rooms, all within the Convention District area. Aloft at Distrito T-Mobile gives us an additional 177 rooms right across the street from our venue.

Transportation: Getting around the Island is a breeze. Rental car agencies can be found near the airport and hotels, also taxi service is a way to see the Island's numerous districts.

Entry Requirements/Currency/Language: As a U.S. Commonwealth, no passports or visas are required for U.S. citizens. Foreign visitors should have valid passports and visas as required. We also use U.S. currency, phone and mail services and both English and Spanish are official languages.

Shipping and Taxes: To ensure you have everything you need for your meeting, Puerto Rico offers convenient and efficient shipping. As Puerto Rico is an Island, there are two choices of shipment, by air or by a combination of land and sea, and we're closer than you think. San Juan, the largest port in the region, is serviced by 23 carriers, and goods leaving the East Coast arrive in the Port of San Juan in about a week. Shipping to Puerto Rico is also affordable and often is considerably less than shipping within the Continental U.S. Once your shipment arrives on the Island, you can choose from 38 highly qualified freight consolidators and/or forwarders. All inbound shipments to the Island are subject to a 6.6% excise tax. Discover Puerto Rico, the official Sales and Marketing agent for the Puerto Rico Convention Center, can provide assistance with filling excise tax exemption letters if exhibit materials will be returning to their point of origin within 60 days.

PUERTO RICO CONVENTION CENTER TECHNICAL SPECIFICATIONS

EXHIBIT AREA

Floors: One - Concrete

Floor load: 350 lb. per sq. ft. (1,709 kg per sq. m.)

Ceiling height: 28 ft. (8.5 m.); unobstructed ceiling with hanging points

Columns: 8 at 90 ft. wide x 150 ft. deep (27 m. wide x m. deep)

Freight doors:

Elephant door at Hall A: 22 ft. w x 27 ft. h (6.2 m. w x 8.2 m. h)

Rolling gates: 24 ft. w x 15.3 ft. h (7.3 m. w x 4.6 m. h)

Freight access: Oversize freight elevator

Operations exit: 13 ft. w (4.0 m. w)

Operations exit: 7' x 10'h (2.1 x 3 m. h)

Elevators:

Freight elevators:

- One elevator, 20,000 lb (9,072 kg)
13 ft. wide x 21 ft. deep x 10 ft. h
(4m. Wide x 6.4 m. deep x 3 m. h)
- Two elevators, 10,000 lb (4,536 kg)
8ft. Wide x 12 ft. deep (2.4 m. wide x 3.7 m. deep)

Passenger elevators:

- Three elevators, 10,000lb (4,536 kg)
8 ft. wide x 10 ft. deep (2.4 m wide x 3 m. deep)

Exhibit booths: 10' x 10' (3 m. x 3 m.)

Approx: 794

Hall A: 210

Hall B: 372

Hall C: 212

Loading docks:

374 linear ft. (114 linear m.)

22 on one level; 6 with automatic leveler

Utilities available in floor boxes:

208V, 30A, 3 phase

208V, 100A, 3 phase, 5 wire quick connect

120V, 20A, GFI with breaker

480V, 1,000A, 3-phase - Only available in Electrical Room Hall B.

Water, 72 p.s.i., 3/4" dm.

Air, compressed in selected boxes

Floor boxes every 30 ft. (9.1 m.) offering voice, data and electricity

Water and drainage boxes every 60 ft. (18.3 m.)

MEETING ROOMS

Floors: Three levels - Carpet

Floor load:

Level 1 - 350 lb. per sq. ft. (1,709 kg per sq. m.)

Level 2 and 3 - 125 lb. per sq. ft. (610 kg per sq. m.)

Ceiling height:

Level 1: 18 ft. (5.5 m.)

Level 2 - 16 ft. (4.9 m.)

Level 3 - 26 ft. (8 m.) and 45 ft. (14 m.); obstructed ceiling

Columns:

Levels 2 and 3 - Column free

Level 3 - 8 columns in pre-function area, 9 ft. wide x 6 ft. deep
(3 m. wide x 2 m. deep)

Utilities available:

Level 1 & 2

120-V, 20-A outlets along perimeter walls

120 outlets at head table locations

Incandescent fluorescent dual system with dimming capabilities

Floor boxes every 30 ft. (9.1 m.) offering voice, data and electricity

Coaxial cable (DVT) to link video signals

Level 3

120V, 30A on perimeter walls

120V, 100A, 3 phase in service corridors

208V, 400A for stage

Dimmable incandescent, programmable controls activated on room divisions.

Floor boxes every 30 ft. (9.1 m.) offering voice, data and electricity

Room sound system, four microphone jacks, coaxial cable (DTV) to link video signals, production intercom system to connect dressing rooms, service and green room.

Back-up generator and water service.

GENERAL INFORMATION

Information Desk: Level 1

Parking Cashier

Food Service Facilities: Four concession strands in Exhibit Hall, theme food carts and vending machines on Level 1. Two freyer Level 1 and activation of theme food C.

Parking:

3,159 self-parking

Valet parking

Taxis

Other services:

Level 1 - Two ATM Machines

Nursing Room

LEVEL ONE - Exhibit Hall

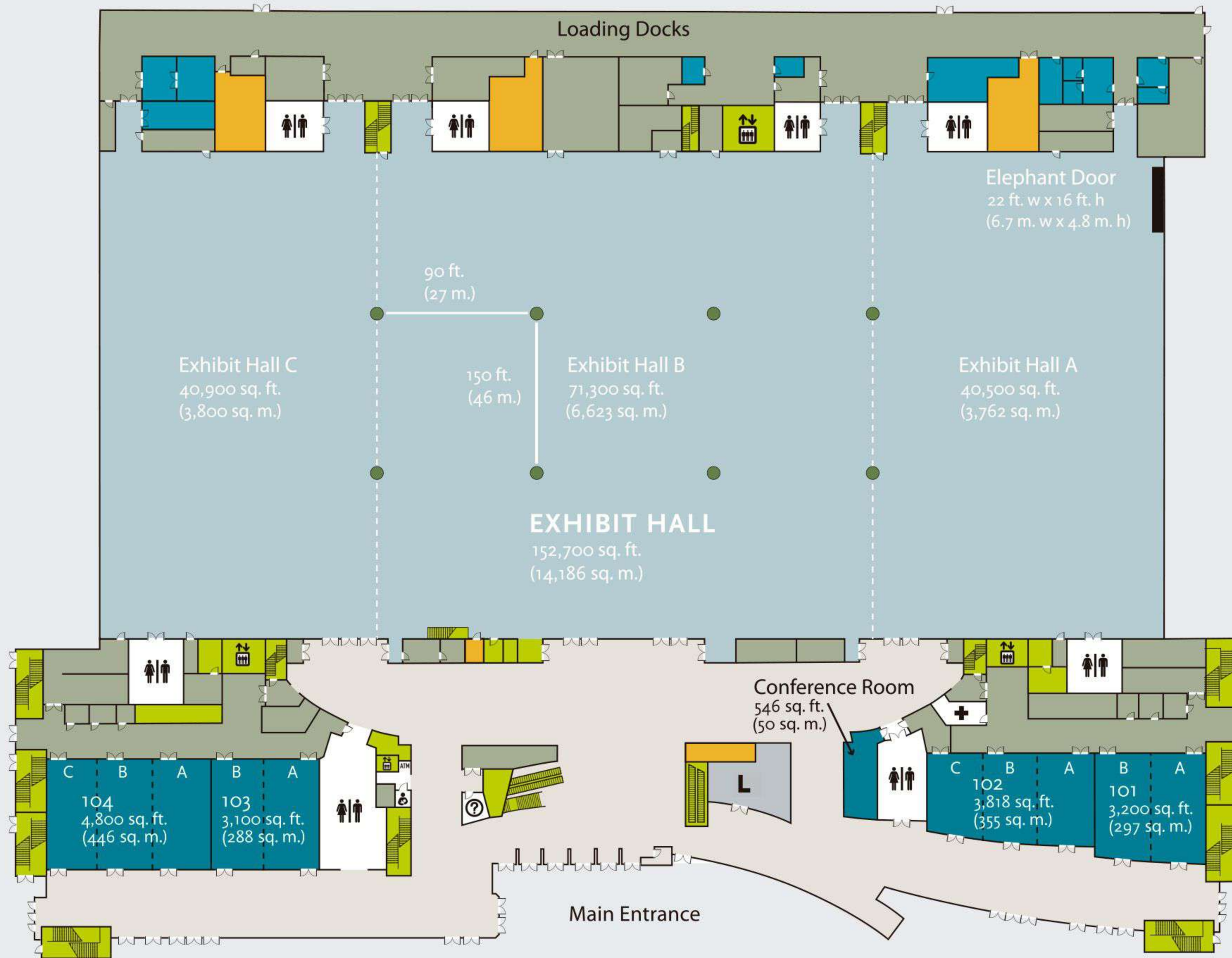

Exhibit Halls & Meeting Rooms	Gross Square Feet	Booth 10'x10'	Seating Capacities*			
			Theater	Banquet	Classroom	Reception
Hall A, B & C	152,700	794	16,576	7,560	7,605	12,000
Hall A	40,500	210	4,140	1,980	2,145	3,500
Hall B	71,300	372	6,510	3,600	3,315	6,500
Hall C	40,900	212	4,140	1,980	2,145	3,500
Meeting Rooms 1st Floor						
Meeting Rooms (Total)	14,900	-	-	-	-	-
Meeting Rm 101 (Total)	3,200	16	334	160	160	336
101-A	1,600	8	156	80	99	168
101-B	1,600	8	156	80	99	168
Meeting Rm 102 (Total)	3,818	18	353	200	198	400
102-A	1,300	5	121	60	81	137
102-B	1,300	6	121	60	81	137
102-C	1,200	7	102	50	58	126
Meeting Rm 103 (Total)	3,100	18	344	200	186	337
103-A	1,500	9	172	80	93	168
103-B	1,600	9	172	80	93	169
Meeting Rm 104 (Total)	4,800	22	506	280	260	505
104-A	1,500	7	156	80	99	158
104-B	1,700	7	156	80	99	179
104-C	1,600	8	156	80	99	168
Chrysler Conference Room	546		Existing Boardroom for 26 people			

Subject to change without notice.

*Seating capacities are subject to change depending on the orientation of the room and the equipment that is being used.

LEVEL TWO - Meeting Rooms

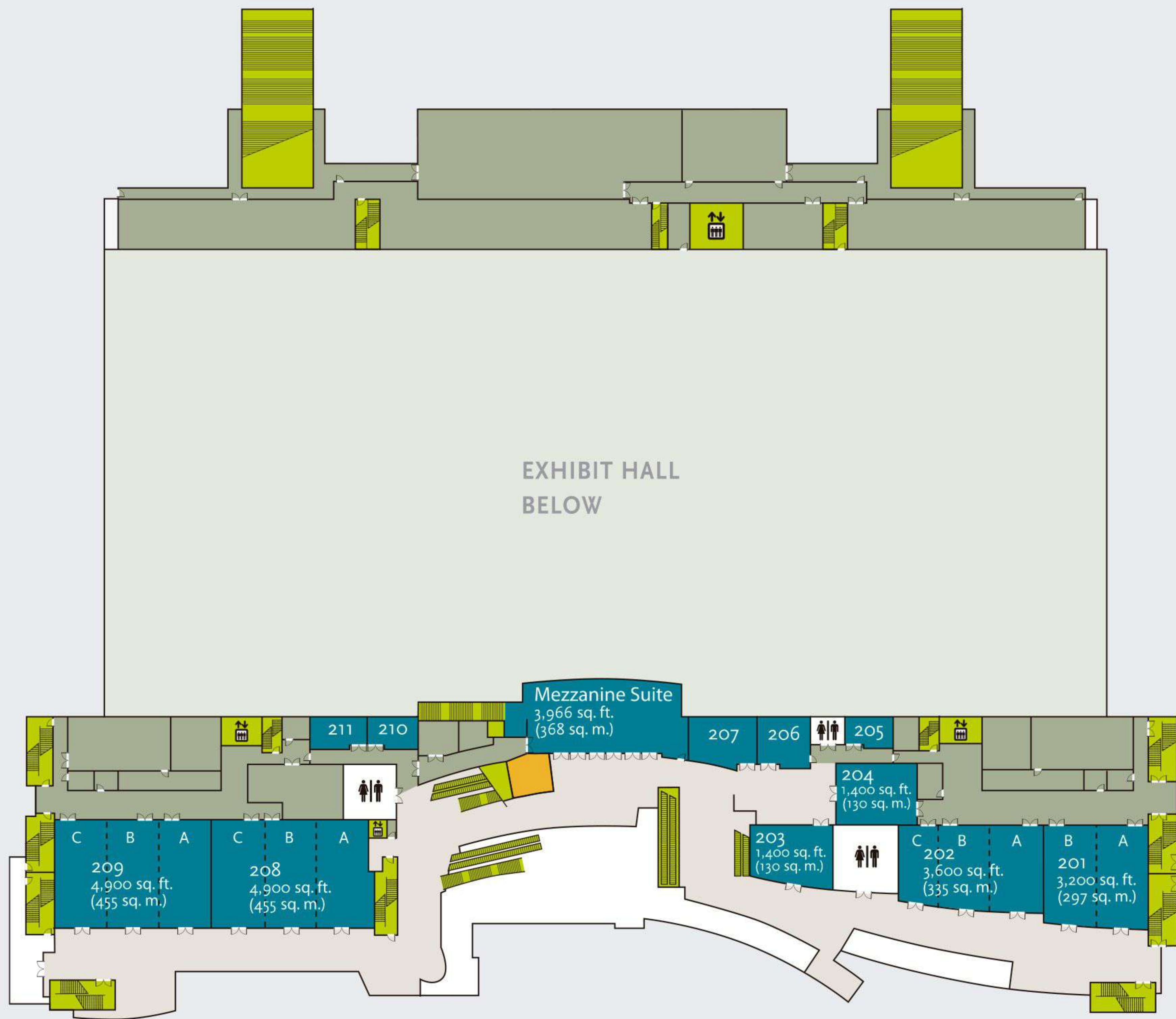

Exhibit Halls & Meeting Rooms	Gross Square Feet	Booth 10'x10'	Seating Capacities*			
			Theater	Banquet	Classroom	Reception
Meeting Rooms 2nd Floor						
Meeting Rooms (Total)	22,659	-	-	-	-	-
Meeting Rm 201 (Total)	3,200	16	288	160	190	336
201-A	1,600	8	144	80	90	168
201-B	1,600	8	144	80	90	168
Meeting Rm 202 (Total)	3,600	12	353	180	200	389
202-A	1,300	6	126	60	84	137
202-B	1,300	5	126	60	84	137
202-C	1,000	3	105	50	56	115
Meeting Rm 203	1,400	7	147	70	80	147
Meeting Rm 204	1,400	7	150	90	96	147
Meeting Rm 205	450	N/A	38	20	49	84
Meeting Rm 206	800	N/A	72	40	49	84
Meeting Rm 207	1,100	N/A	106	60	60	116
Meeting Rm 208 (Total)	4,900	22	600	280	327	516
208-A	1,600	9	170	80	99	168
208-B	1,700	8	170	80	99	180
208-C	1,600	8	170	80	99	168
Meeting Rm 209 (Total)	4,900	22	567	280	315	516
209-A	1,600	8	156	80	99	168
209-B	1,700	7	156	80	99	180
209-C	1,600	8	156	80	99	168
Meeting Rm 210	400	N/A	40	20	27	35
Meeting Rm 211	537	N/A	40	20	27	50
Mezzanine Suite	3,966	N/A	320	180	195	400

LEVEL THREE - Ballroom

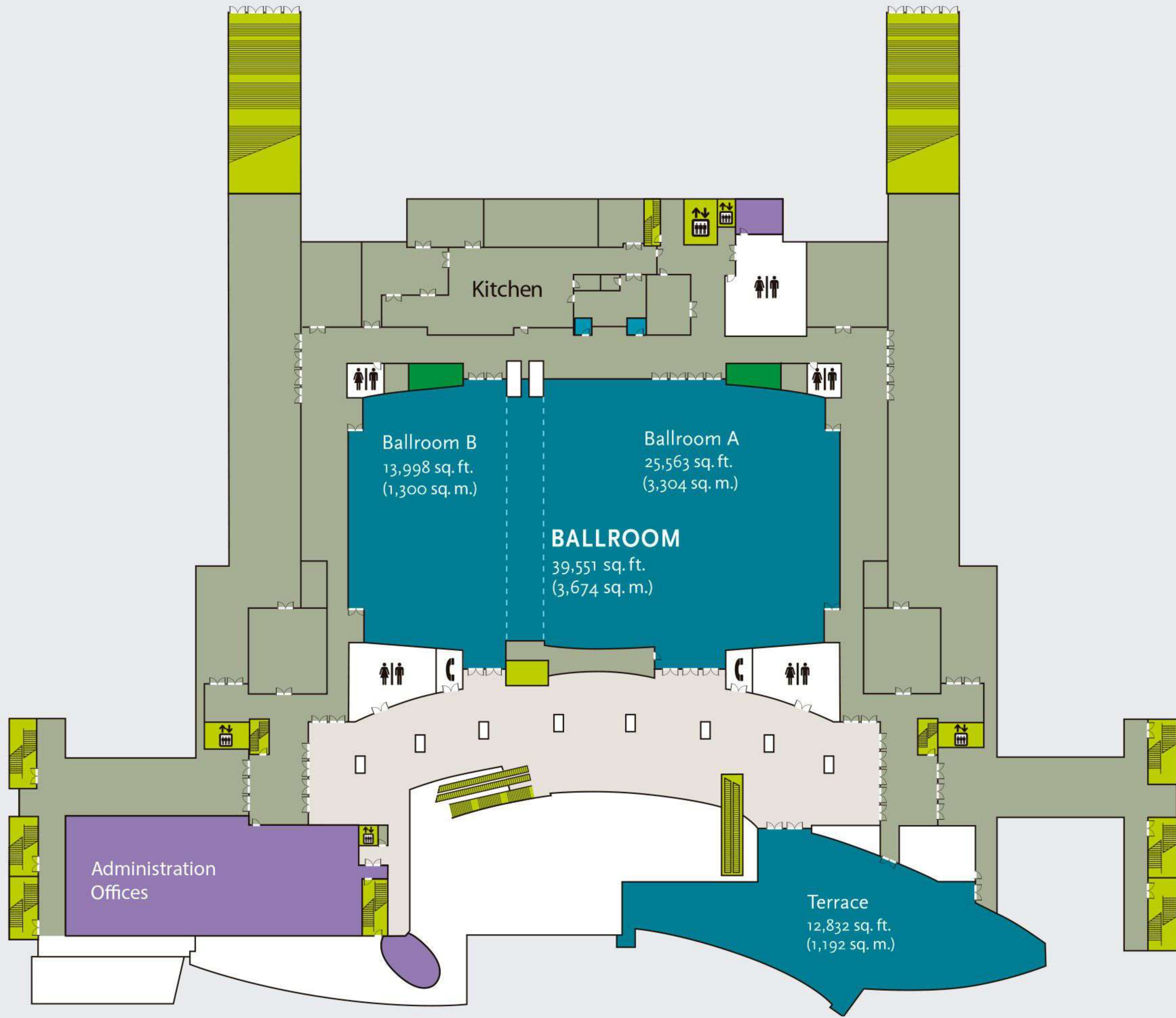









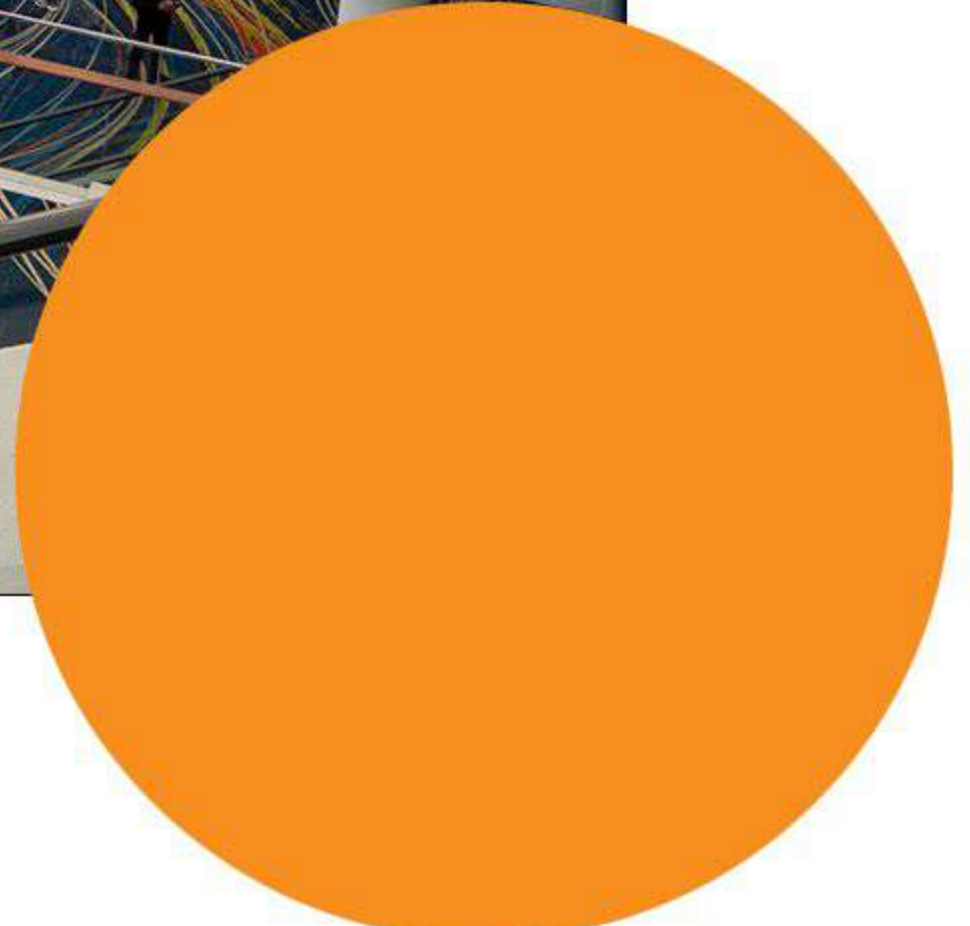
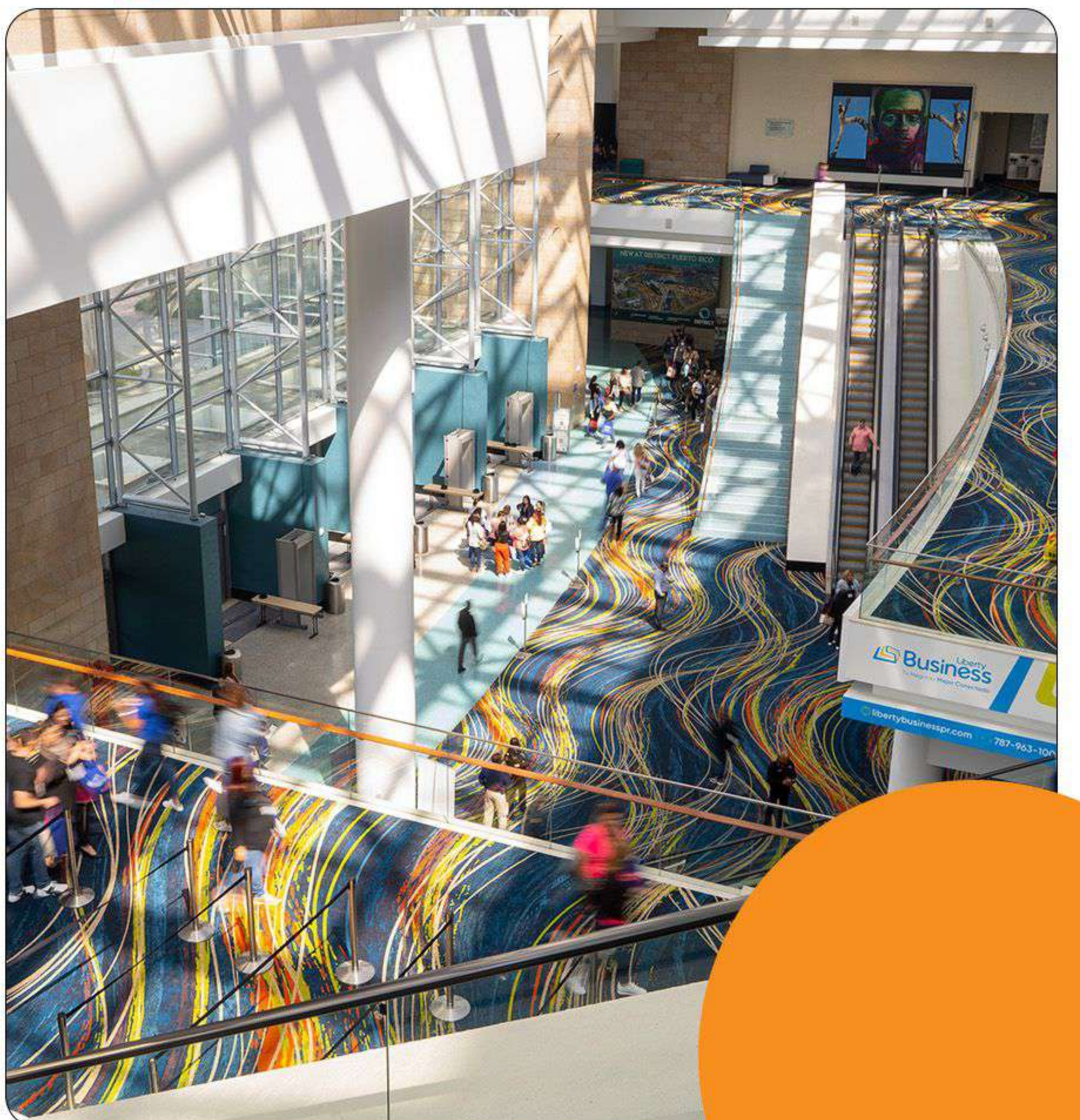
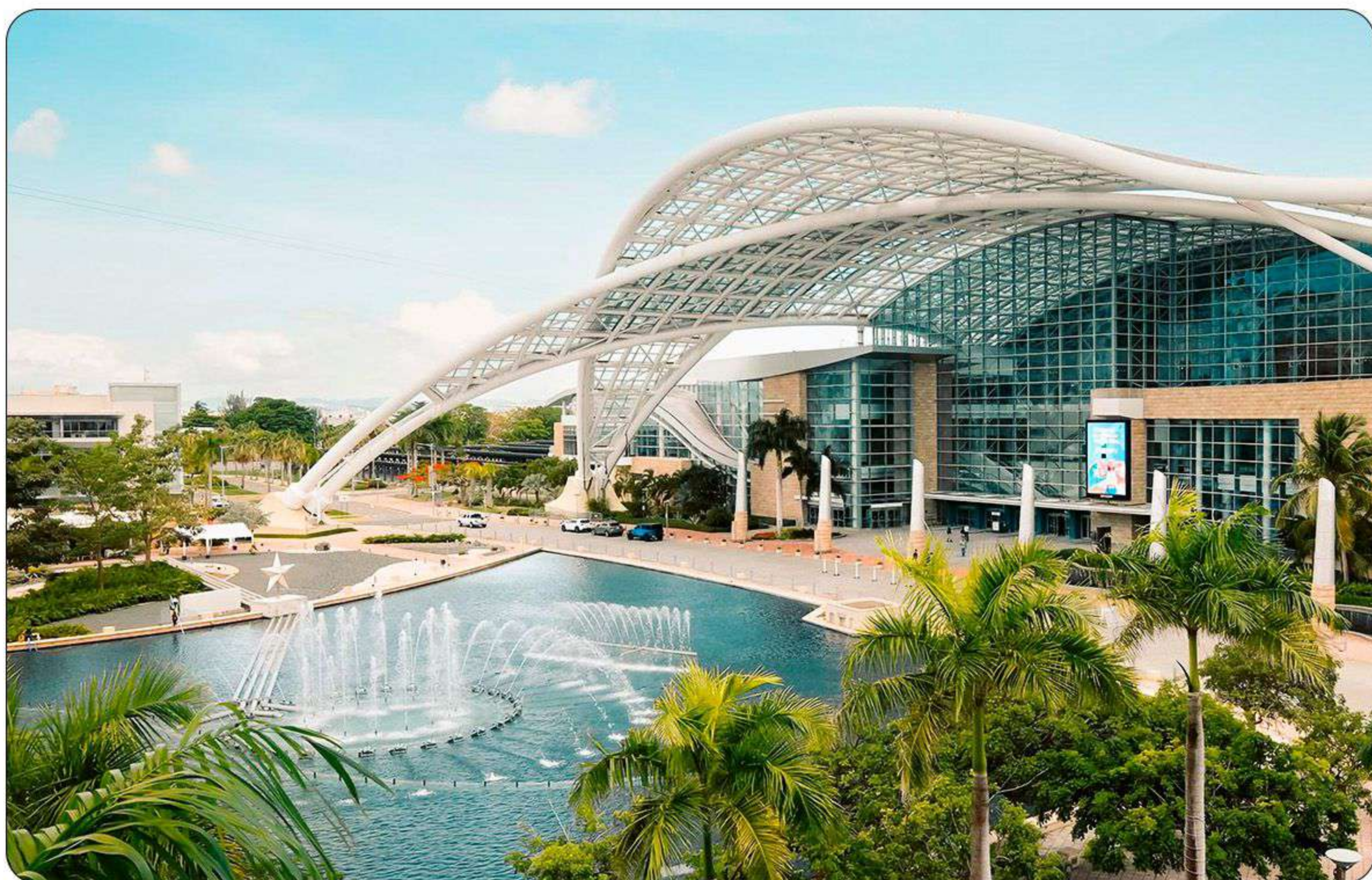
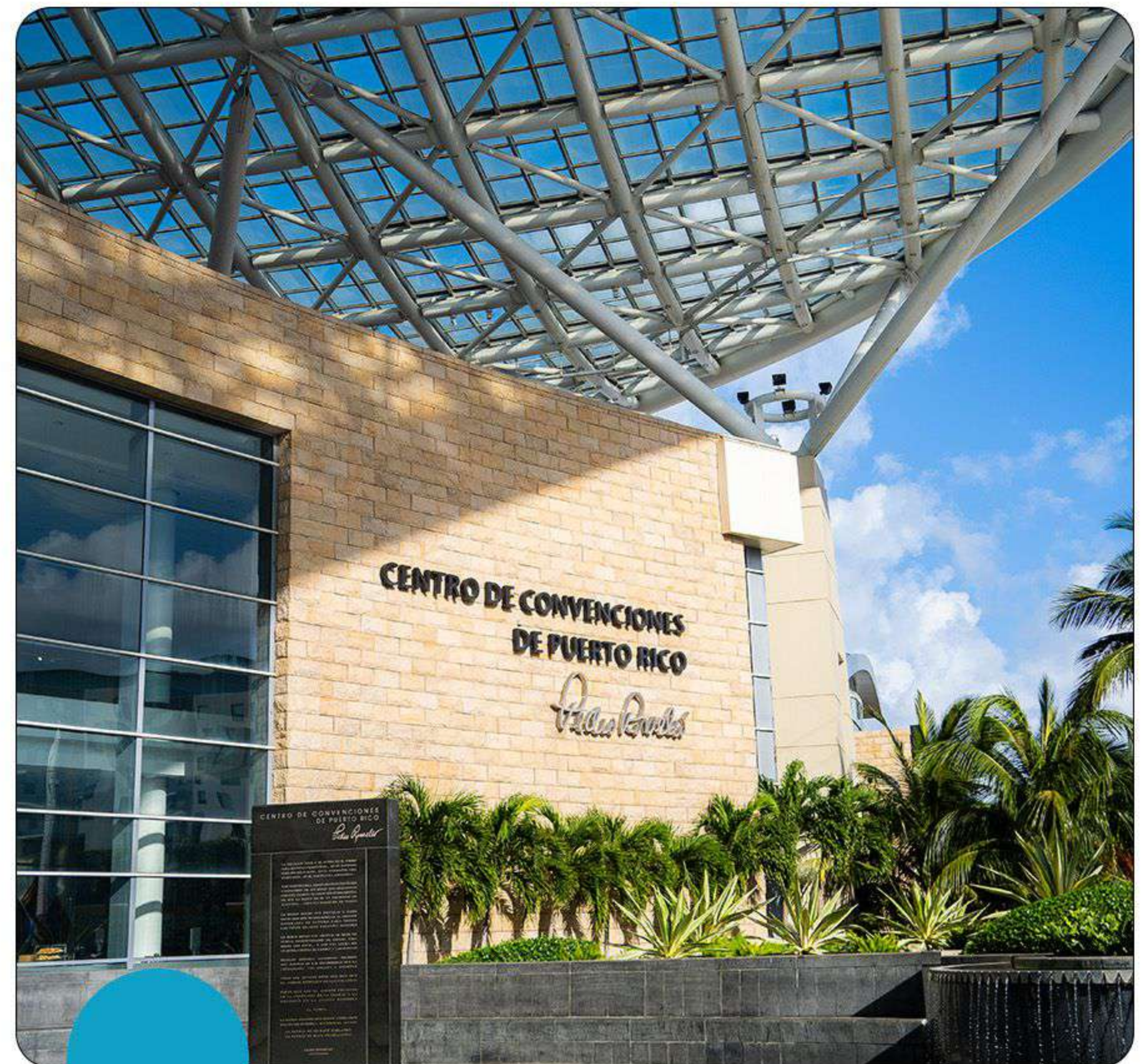
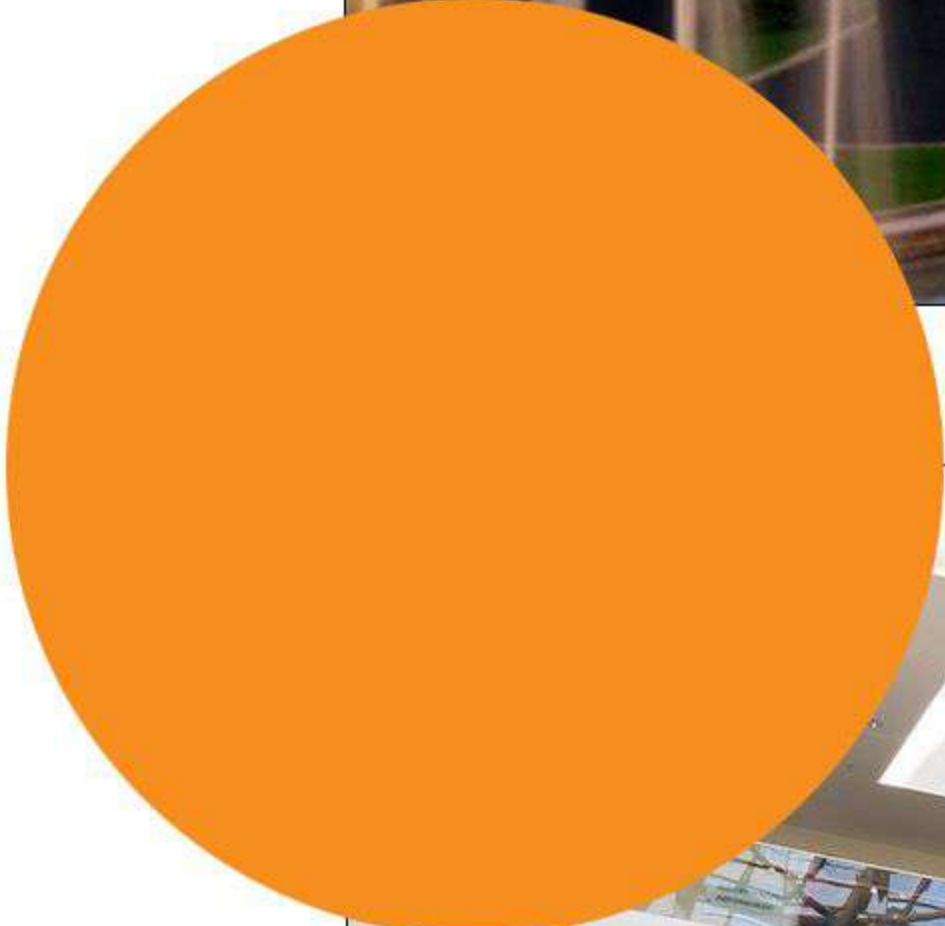
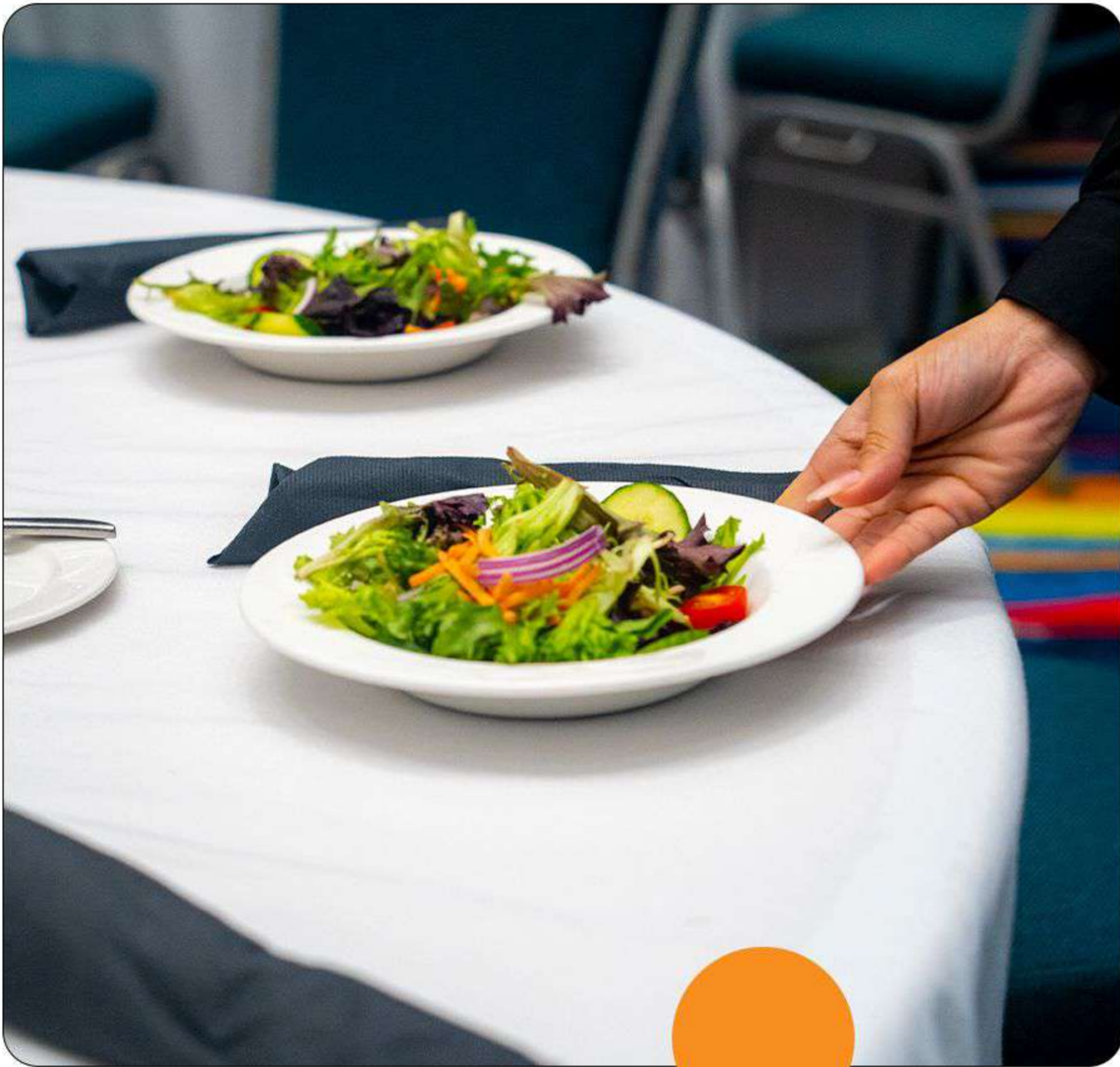

Exhibit Halls & Meeting Rooms	Gross Square Feet	Seating Capacities*			
		Theater	Banquet	Classroom	Reception
3rd Floor					
Ballrooms A & B (Total)	39,551	3,900	2,130	2,676	3,934
A	25,563	2,340	1,320	1,710	2,450
B	13,988	1,260	590	858	1,288
Terrace	12,832	-	600	-	1,200

-  Back of the House
-  Meeting Space
-  VIP Lounge
-  Restrooms
-  Concessions
-  Office Space
-  First Aid
-  Telephone
-  Escalators, Elevators, Stairs
-  Public Circulation
-  Help Desk
-  Elevator
-  Exhibit Hall
-  Green Room
-  Mother's Room
-  ATM Machine





PRCONVENTION.COM

| 787-641-7722 |

